

H  
Ref  
8912.778  
C796

PUBLIC LIBRARY  
KANSAS CITY

# PLAT BOOK

OF

COOPER COUNTY,  
MISSOURI

Published by  
W.W.HIXSON & CO.  
Rockford, Illinois

9912.778 C77h  
Kansas City  
Public Library



This Volume is for  
REFERENCE USE ONLY

KANSAS CITY, MO. PUBLIC LIBRARY



0 0001 4705295 5

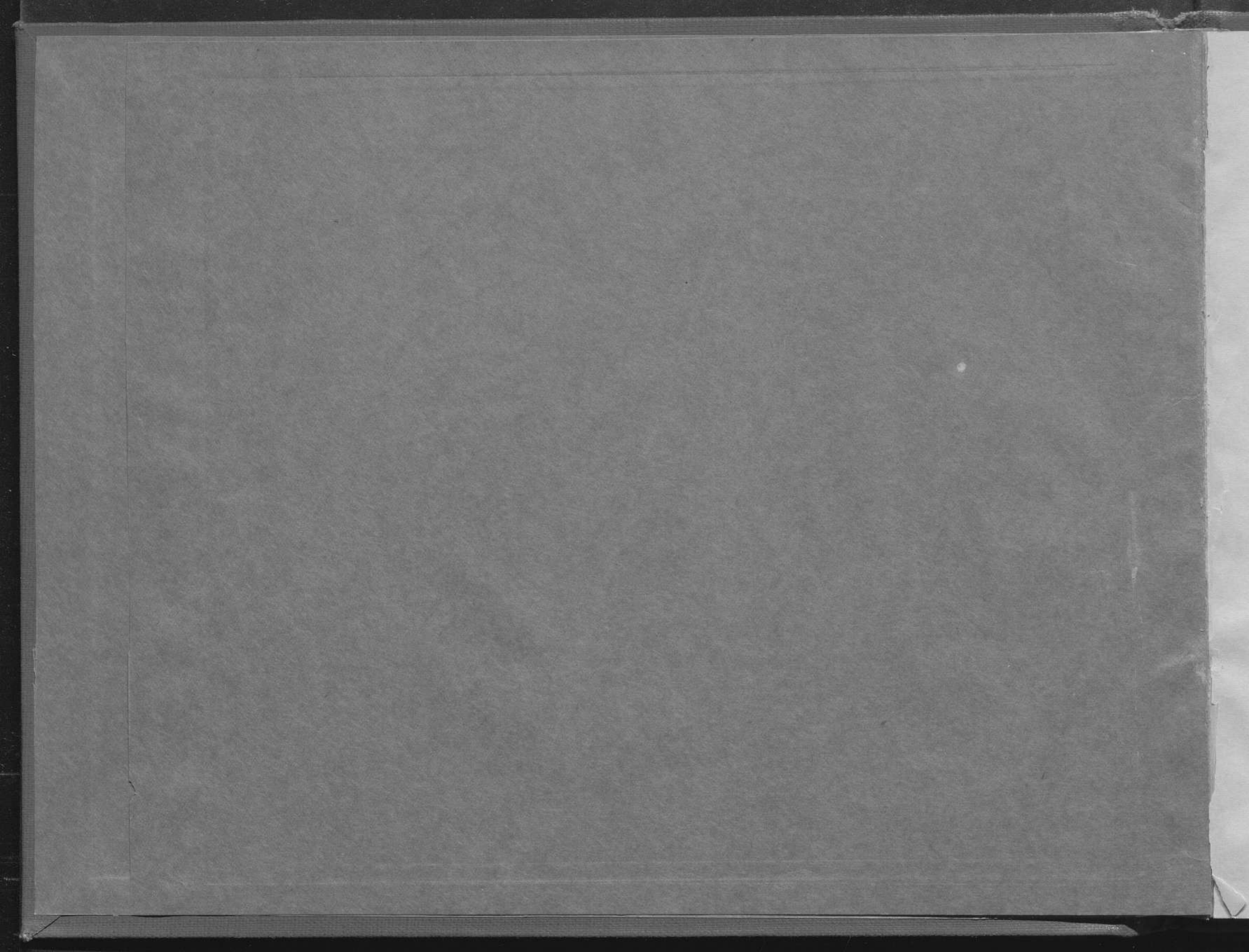

COOPER

COUNTY

MISSOURI

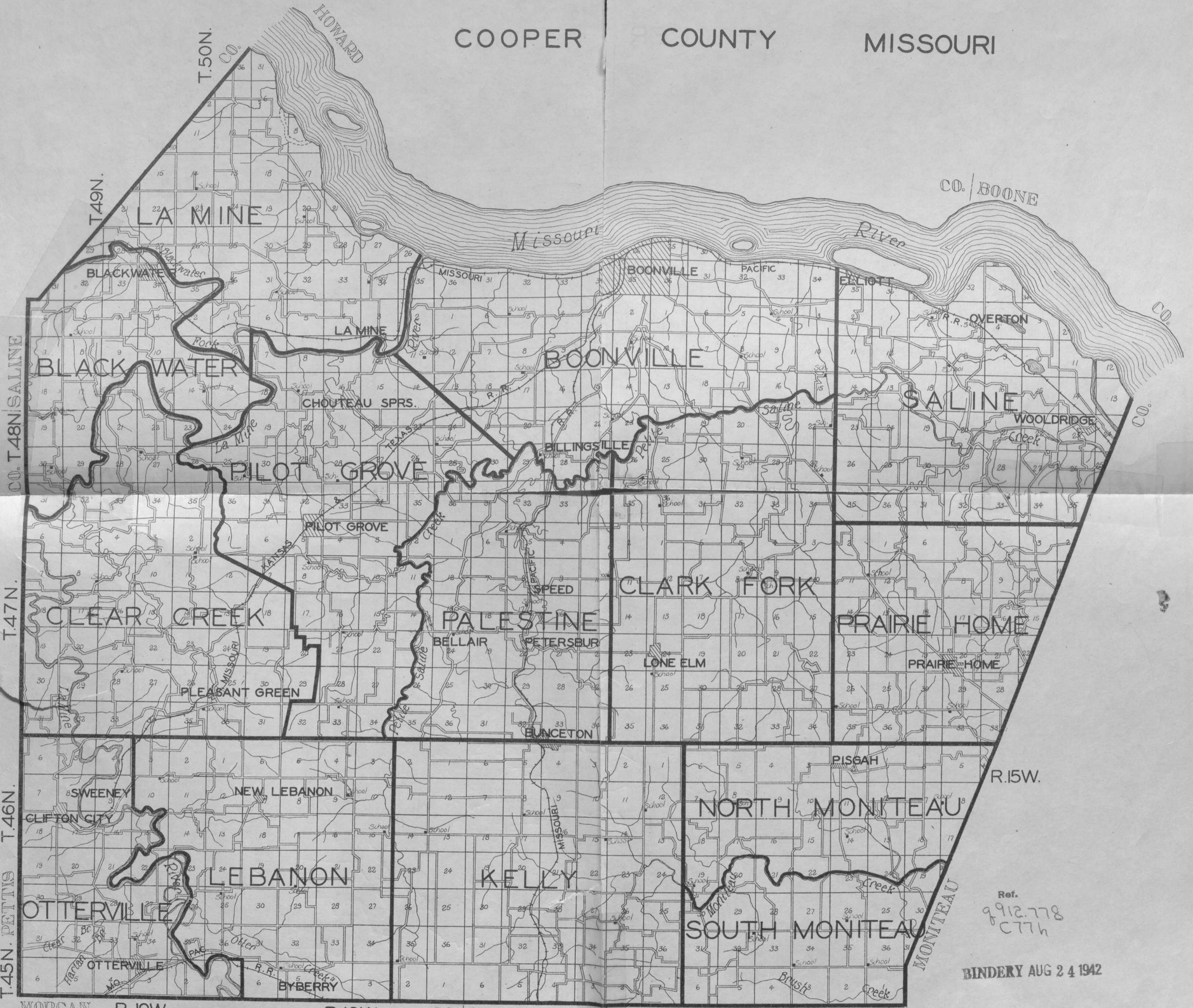

CO. BOONE

CO.

CO.

CO. T.48N. SALINE

T.47N.

T.46N.

T.45N. PETTIS

R.15W.

MORGAN R.19W.

R.18W.

CO. MONITEAU R.17W.

R.16W. CO.

Ref. 9912.778 C77h

BINDERY AUG 24 1942

Mapson 50

611844 Ms 1 '20

T.47N. PART OF PRAIRIE HOME R.15W.

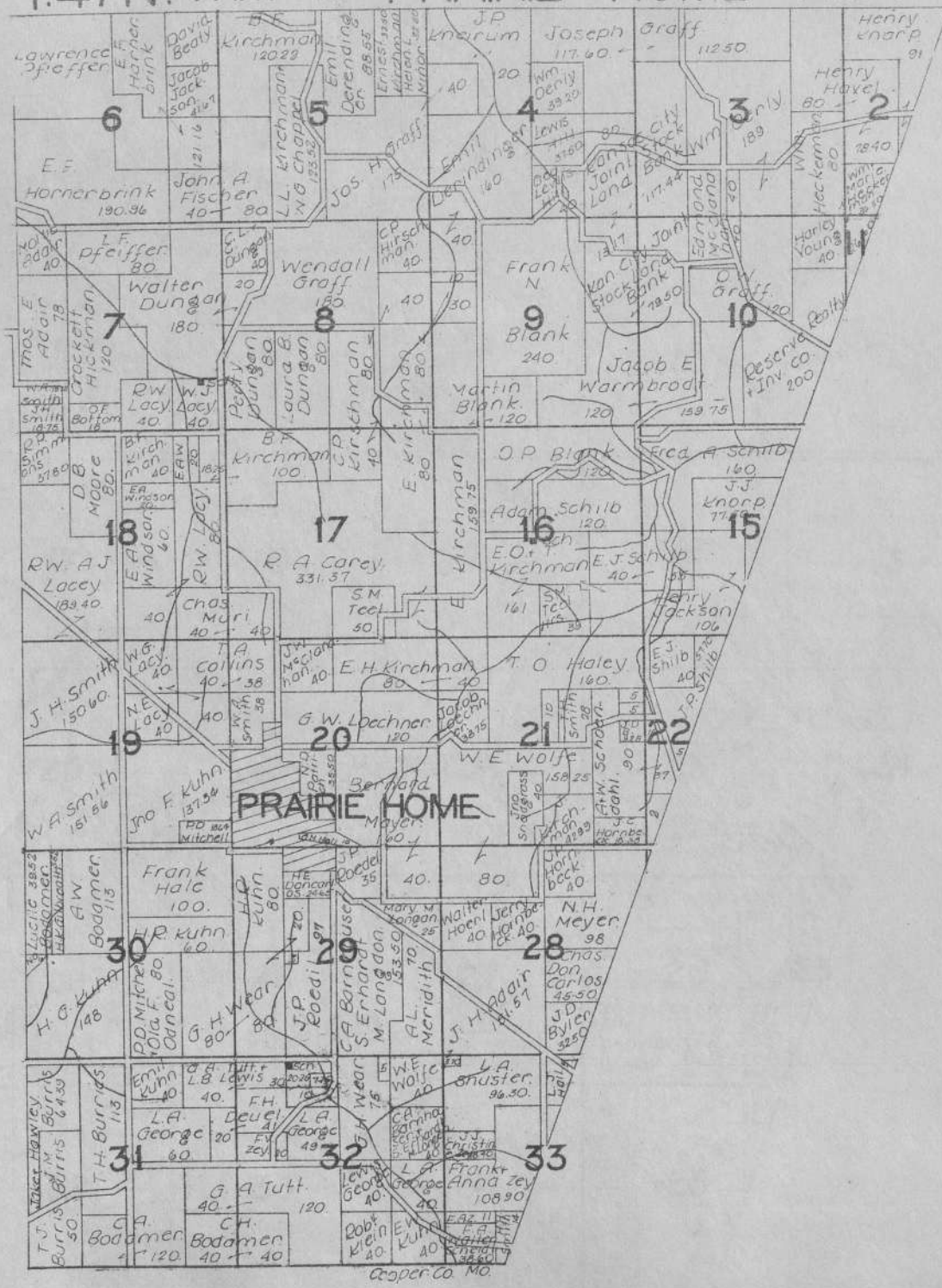

T.48&49 N. PART OF SALINE R.15W.



T.45 & 46N.

R.15 & 16W.



T.47N.

R.16W.

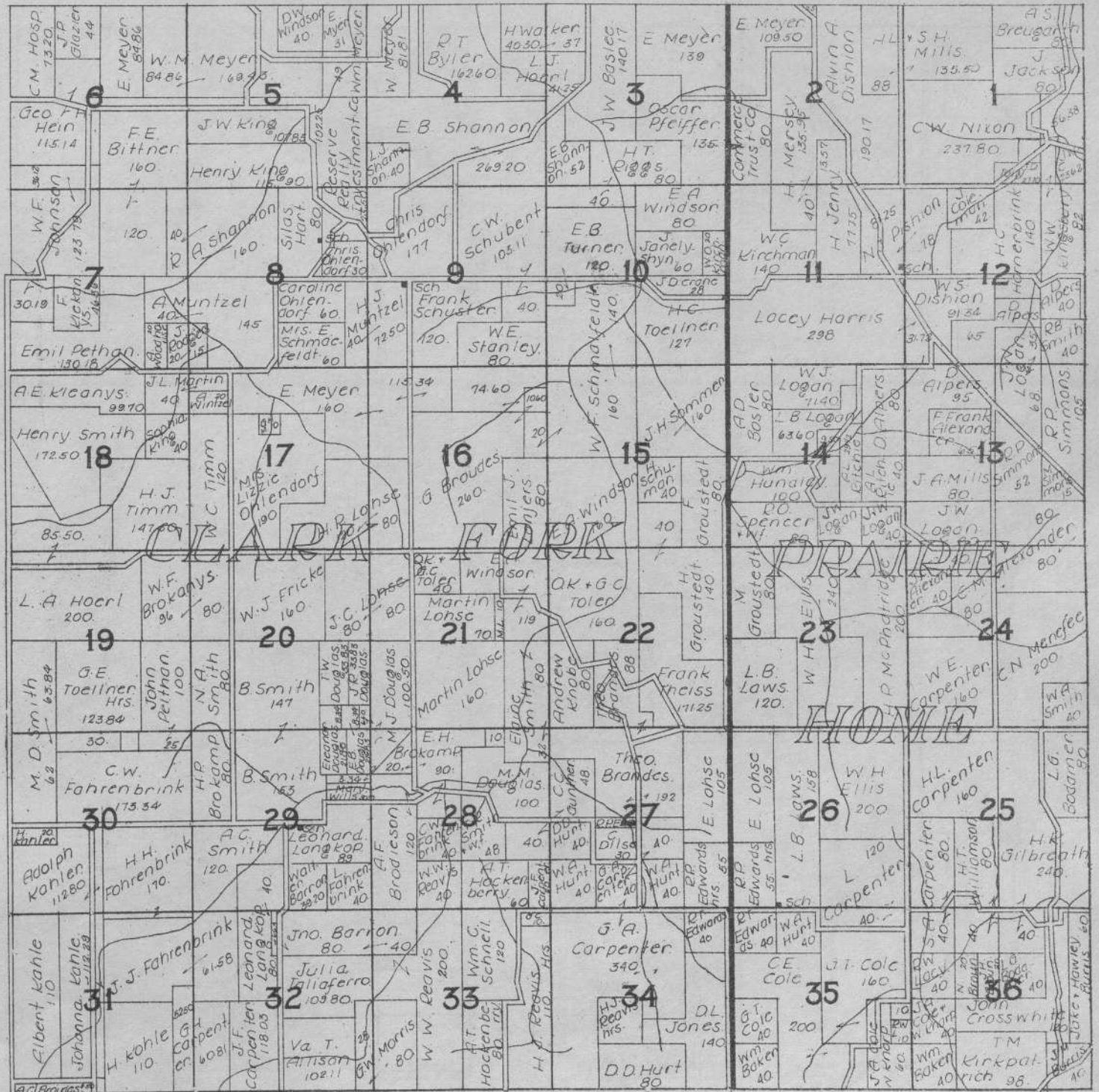

Traver Co MO

T.48 & 49N.

R.16 W.

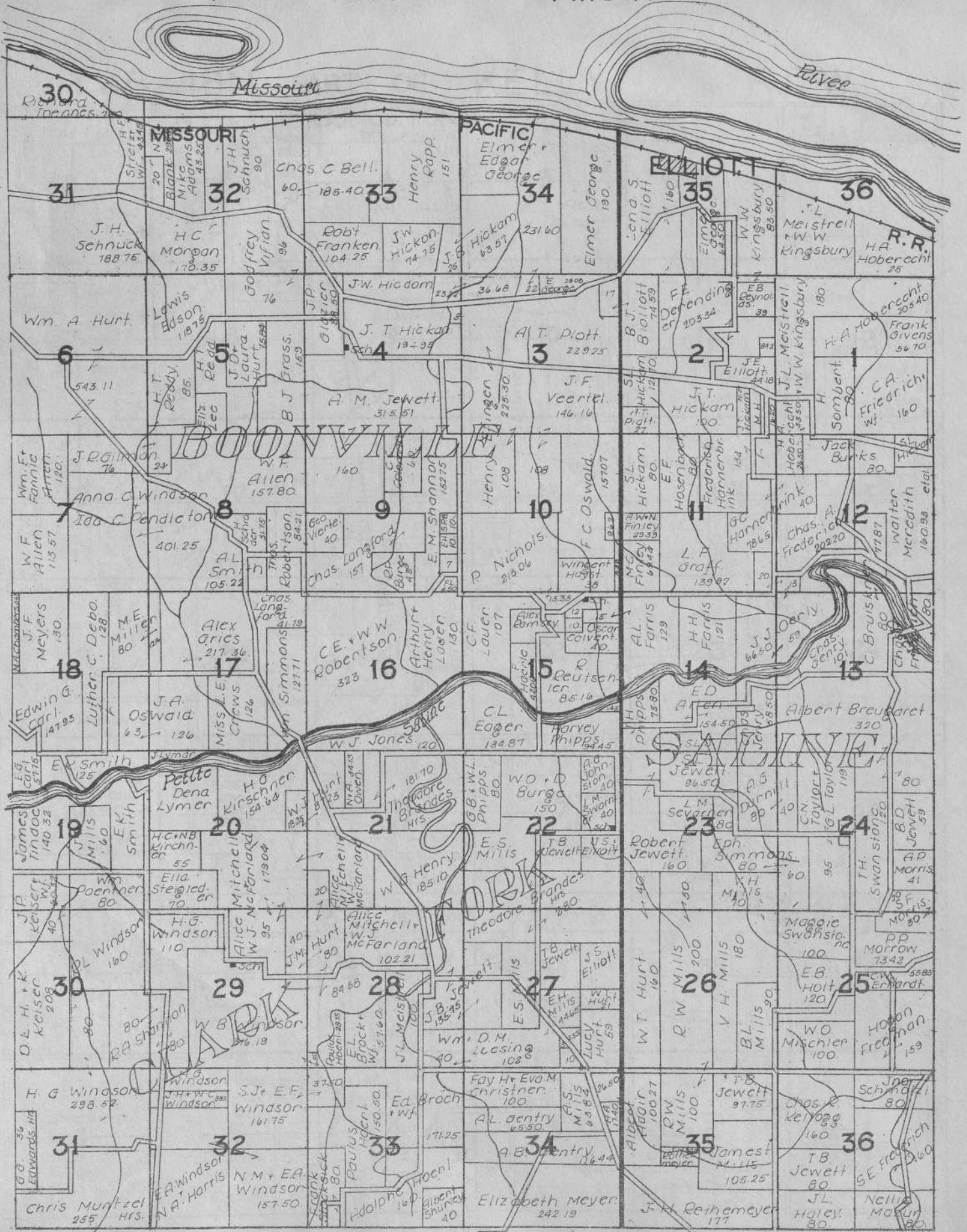

Cooper Co. Mo

T.45&46N. PART OF KELLY R.17W.

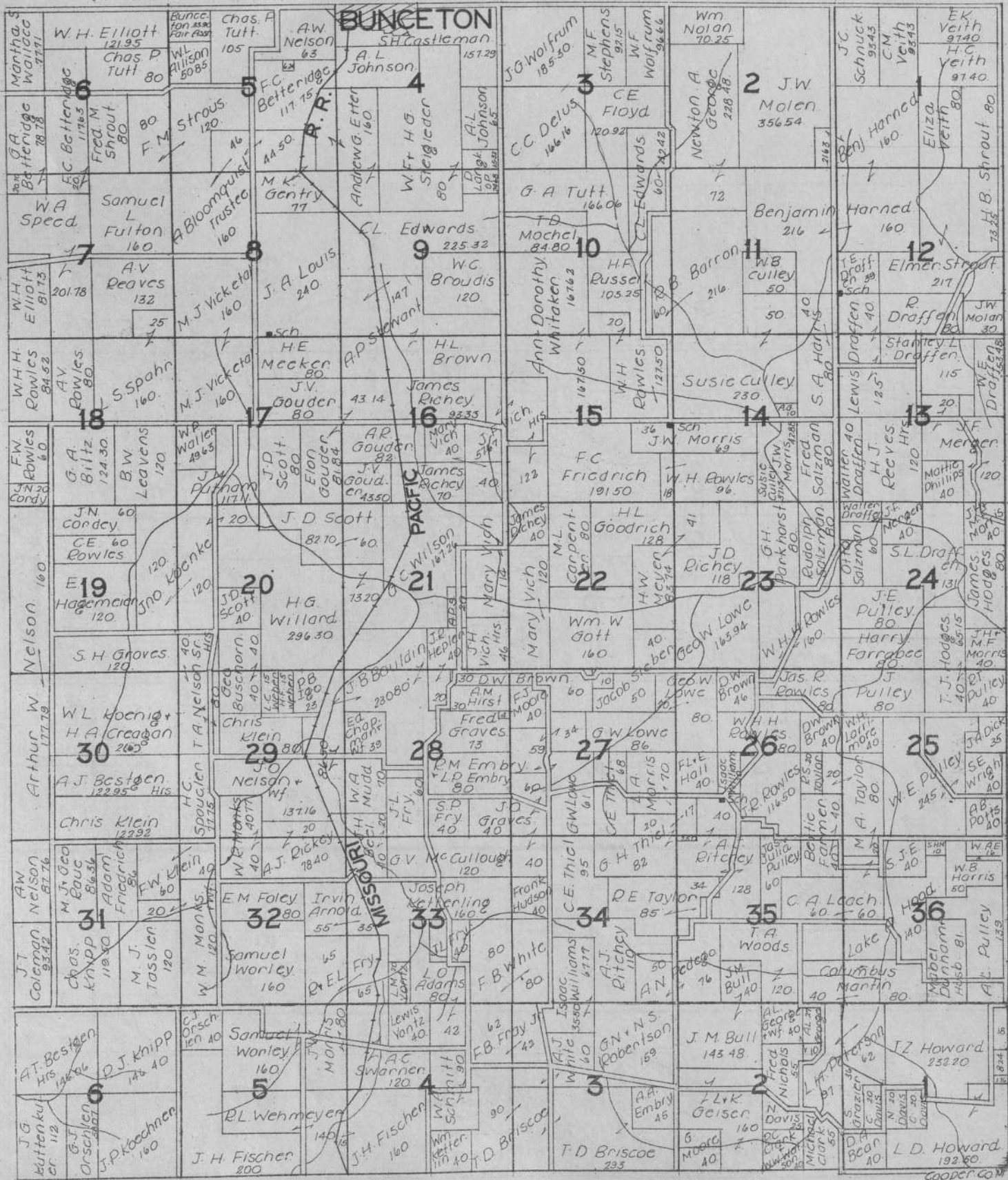

T. 47N.

R. 17 W.

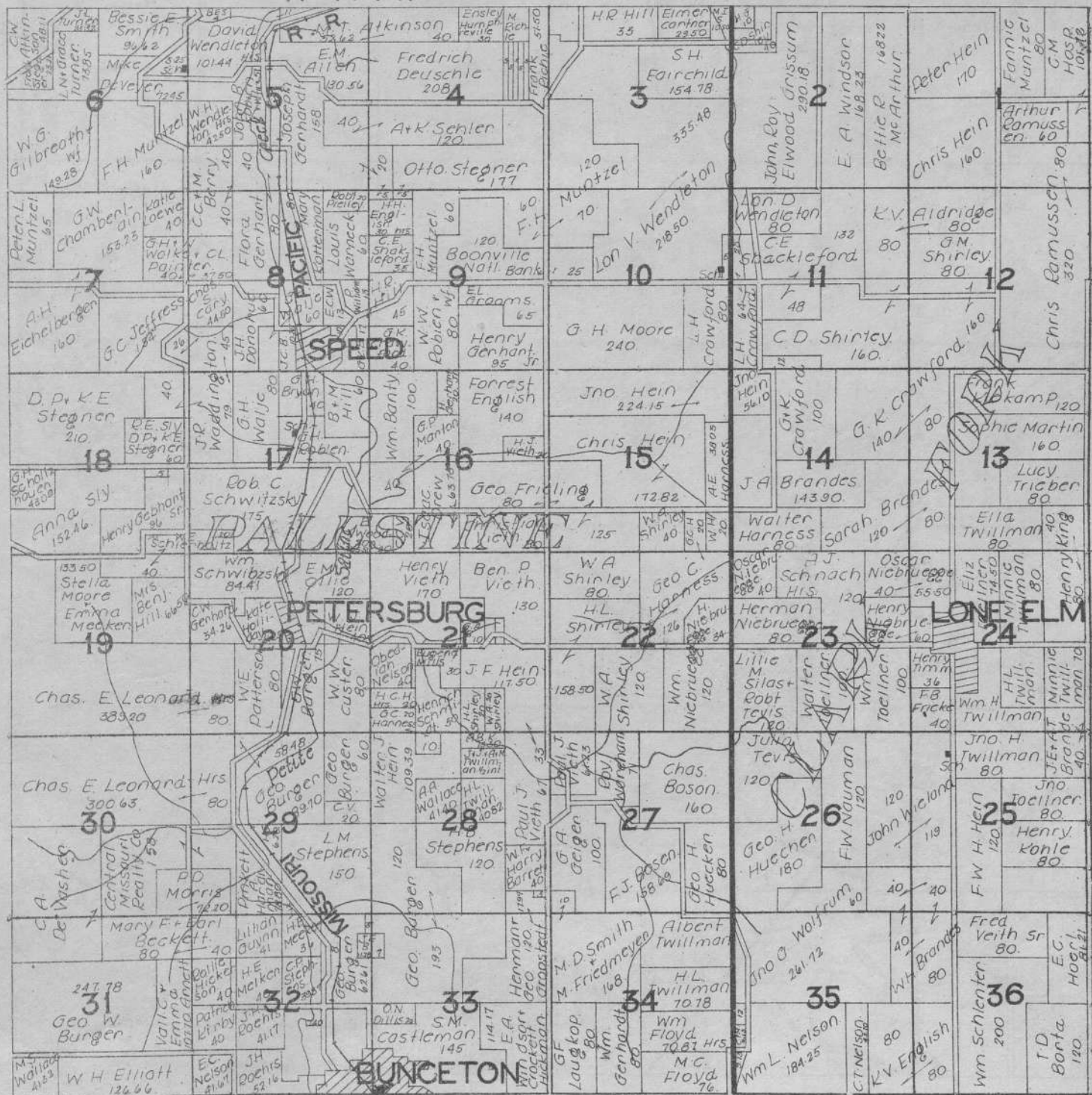







T.48N.

R.18W.



T.49 & 50 N. R.18 W.



Cooper Co Mo



T.47N.

R.19W.



T.48N.

R.19W.



T.49 & 50N.

R.19W.

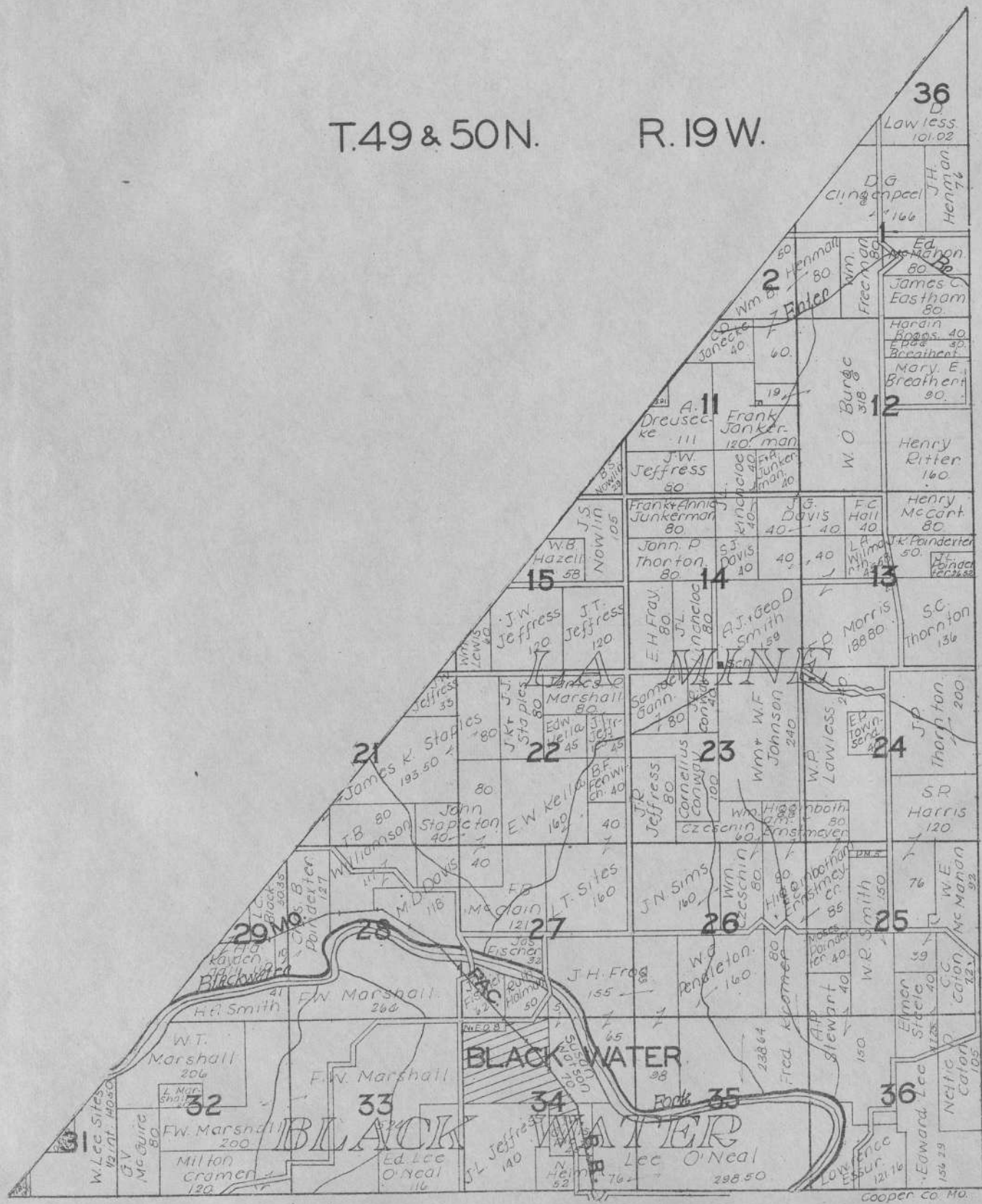

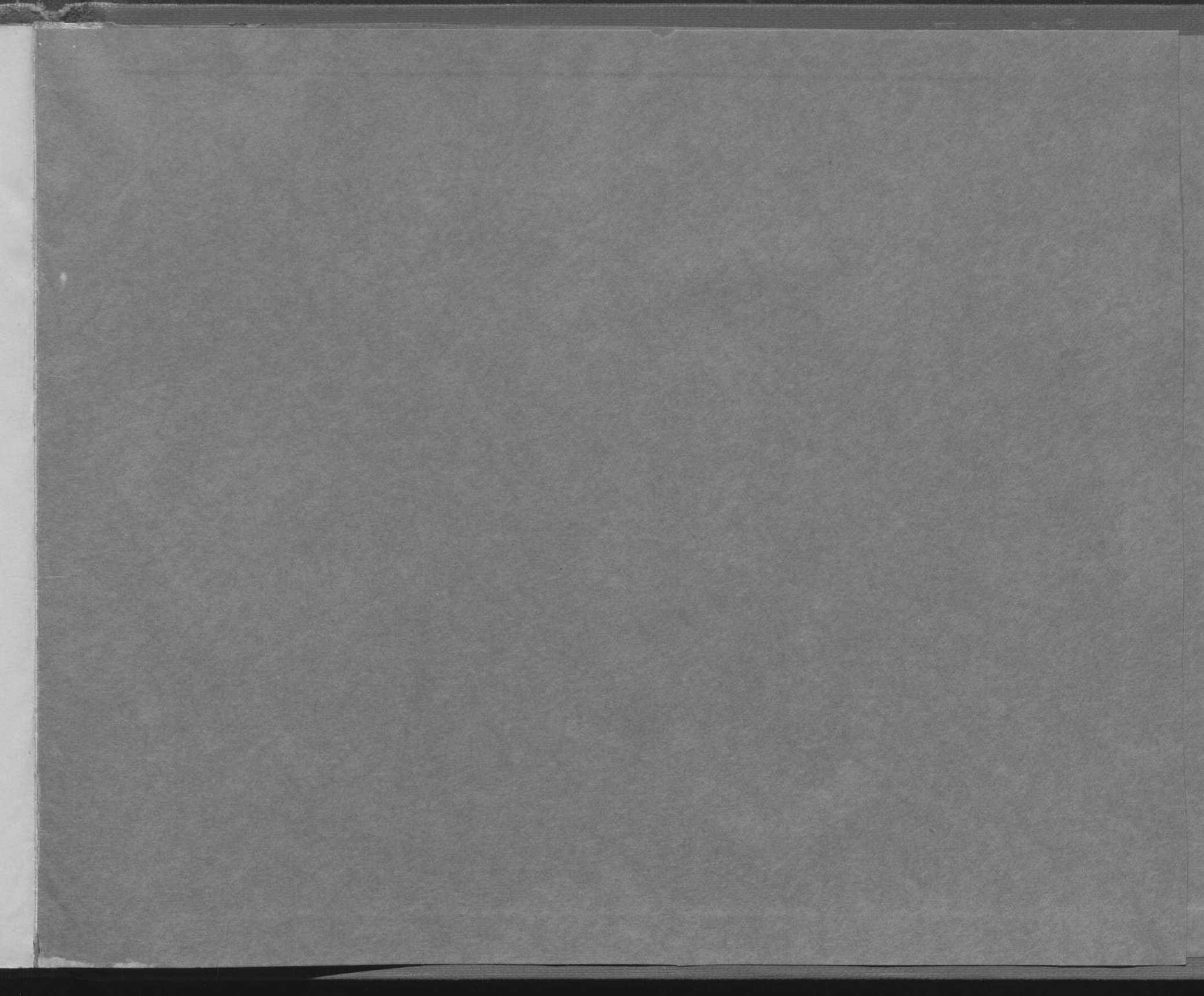



**REFERENCE**

**ONLY**

